

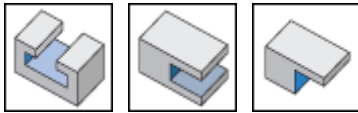

ETS : T-slot endmills.

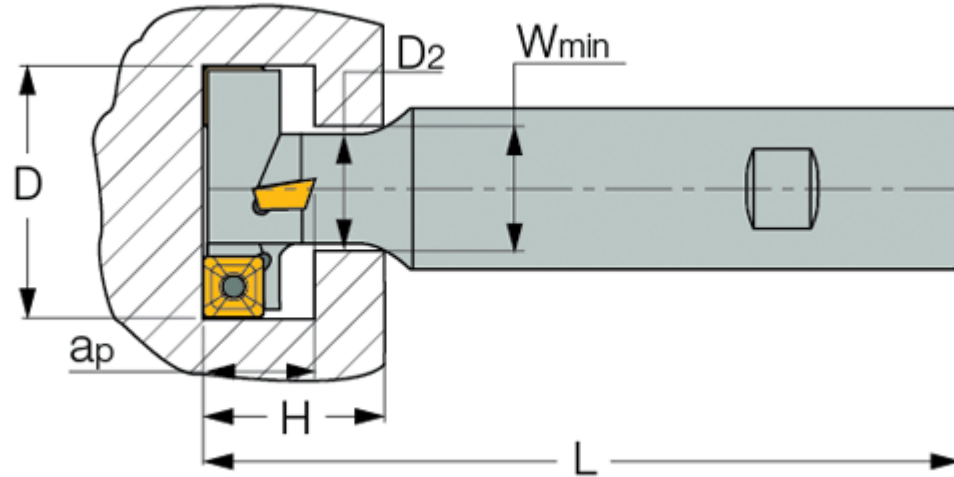

Designation	D	Z	Zeff	D2	W min	ap	H	L	d	Shank	Kg
ETS D21-9-W16-06	21.10	2	1	10.80	12.00	8.85	26.90	90.00	16.00	W	0.11
ETS D25-11-W16-06	24.80	4	2	12.80	14.00	10.80	23.70	90.00	16.00	W	0.12
ETS D25-11-W25-06	24.80	4	2	12.80	14.00	10.80	24.40	120.00	25.00	W	0.36
ETS D32-14-W32-10	31.70	2	1	16.70	18.00	13.85	40.00	120.00	32.00	W	0.53
ETS D32-14-W16-10	31.70	4	2	16.00	18.00	13.85	52.00	90.00	16.00	W	0.13
ETS D32-16-W32-A10	31.70	4	2	16.80	18.00	15.85	39.00	110.00	32.00	W	0.48
ETS D40-18-W32-10	39.70	4	2	20.70	22.00	17.85	50.00	130.00	32.00	W	0.61
ETS D48-22-W32-15	48.50	4	2	26.00	27.00	21.85	51.30	130.00	32.00	W	0.73