

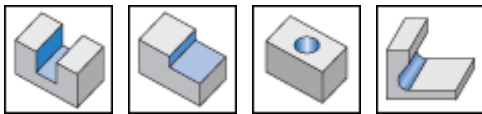

**HCE-MM** : BALLPLUS, multifunction endmills with a MULTI-MASTER threaded adaptation which can carry ball nose, 90° and toroidal

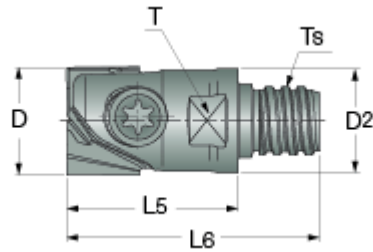

Designation	D	L6	L5	Ts	D3	T	Kg
HCE D12/.50-MMT08	12.00	28.00	20.00	T8	11.50	10.0	0.00
HCE D16/.62-MMT10	16.00	36.75	25.00	T10	15.20	13.0	0.12
HCE D20/.75-MMT12	20.00	48.80	35.00	T12	18.50	15.0	1.40

For undercutting use HTR inserts only.  
 The dimensions are for HCC inserts with  $r=0.5$  mm (.02").  
 For tightening torque click on "More Info".