

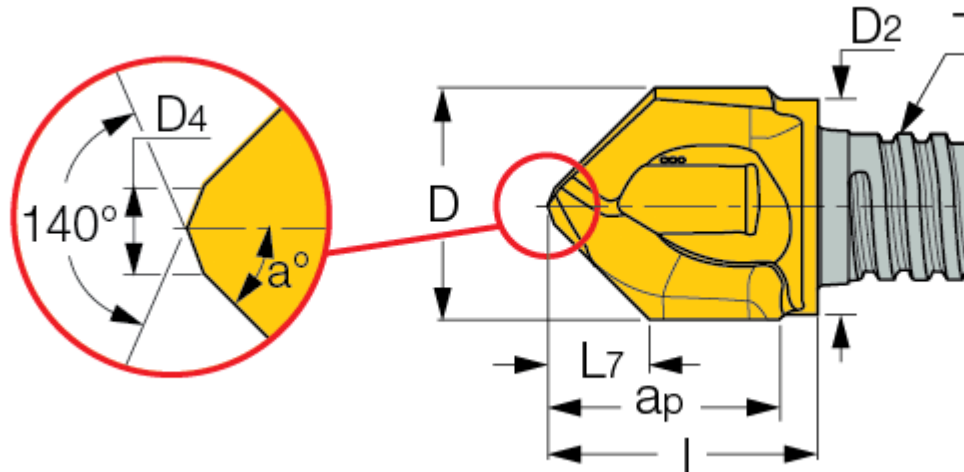

MM HCD : MULTI-MASTER, 2 flute interchangeable solid carbide heads, for chamfering, countersinking and spot drilling.

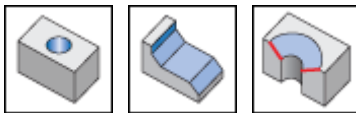

Economical solution



Designation	D	Dtol	Z	ap	Ts	D2	l	a°	L7	D4	Grade
MM HCD080-090-2T05	8.00	z9	2	7.00	T05	7.60	9.75	45	3.70	1.00	IC908
MM HCD083-090-2T05	8.30	z9	2	7.50	T05	7.60	10.00	45	3.80	1.00	IC908
MM HCD100-090-2T06	10.00	z9	2	9.00	T06	9.60	11.75	45	4.50	1.50	IC908
MM HCD100-060-2T06	10.00	h10	2	9.50	T06	9.60	11.75	30	7.60	1.50	IC908
MM HCD100-120-2T06	10.00	h10	2	9.50	T06	9.60	12.70	60	2.70	1.50	IC908
MM HCD104-090-2T06	10.40	z9	2	9.00	T06	9.60	11.75	45	4.70	1.50	IC908
MM HCD120-090-2T08	12.00	z9	2	7.00	T08	11.50	15.50	45	5.50	1.50	IC908
MM HCD120-060-2T08	12.00	h10	2	12.00	T08	11.50	15.20	30	9.30	1.50	IC908
MM HCD120-120-2T08	12.00	h10	2	12.00	T08	11.50	15.20	60	3.50	1.50	IC908
MM HCD124-090-2T08	12.40	z9	2	12.00	T08	11.50	15.35	45	5.70	1.50	IC908
MM HCD.500-080-2T08	12.70	z9	2	12.00	T08	11.50	15.30	40	6.90	1.50	IC908
MM HCD160-090-2T10	16.00	z9	2	15.00	T10	15.20	18.80	45	7.50	1.50	IC908
MM HCD160-060-2T10	16.00	h10	2	16.50	T10	15.20	20.20	30	12.00	2.50	IC908
MM HCD160-120-2T10	16.00	h10	2	15.50	T10	15.20	19.90	60	4.40	1.50	IC908
MM HCD165-090-2T10	16.50	z9	2	15.00	T10	15.20	18.80	45	7.50	1.50	IC908
MM HCD200-090-2T12	20.00	z9	2	18.50	T12	18.30	24.70	45	7.70	1.50	IC908
MM HCD200-060-2T12	20.00	h10	2	18.50	T12	18.30	24.70	30	15.50	2.50	IC908
MM HCD200-120-2T12	20.00	h10	2	14.90	T12	18.30	21.10	60	5.90	1.50	IC908

For Clamping keys (should be ordered separately), tightening torques and clamping instructions, click on "More Info".

Do not apply lubricant to the threaded connection.