

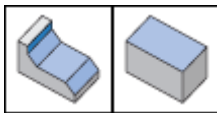

**F45NM** : 16MILL, screw lock, 45°face mills, using Octagonal ONHU/MU 0806... inserts with 16 cutting edges. Feature high table speed

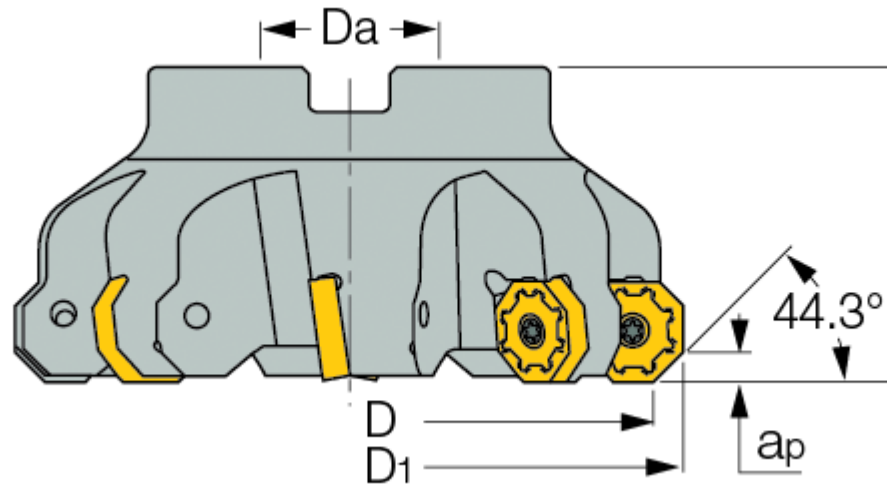

Designation	D	D1	Z	ap	L	Da	Arbor	Kg
F45NM D063-05-22-R08	63.00	75.5	5	5.50	40.00	22.00	A	0.63
F45NM D080-06-25.40-R08	80.00	92.0	6	5.50	50.00	25.40	B	1.15
F45NM D080-06-27-R08	80.00	92.5	6	5.50	50.00	27.00	B	1.22
F45NM D080-08-27-R08	80.00	92.5	8	5.50	50.00	27.00	B	1.17
F45NM D100-07-31.75-R08	100.00	112.0	7	5.50	50.00	31.75	B	1.96
F45NM D100-07-32-R08	100.00	112.5	7	5.50	60.00	32.00	B	1.54
F45NM D100-10-32-R08	100.00	112.5	10	5.50	60.00	32.00	B	1.32
F45NM D125-08-38.10-R08	125.00	137.0	8	5.50	63.00	38.10	B	3.11
F45NM D125-08-40-R08	125.00	137.5	8	5.50	63.00	40.00	B	2.93
F45NM D125-12-40-R08	125.00	137.5	12	5.50	63.00	40.00	B	3.50
F45NM D160-10-40-R08	160.00	172.5	10	5.50	63.00	40.00	C	4.54
F45NM D160-15-40-R08	160.00	172.5	15	5.50	63.00	40.00	C	2.00
F45NM D200-12-60-R08	200.00	212.5	12	5.50	63.00	60.00	C	7.98
F45NM D200-18-60-R08	200.00	212.5	18	5.50	63.00	60.00	C	4.32
F45NM D250-14-60-R08	250.00	262.5	14	5.50	63.00	60.00	C	3.33
F45NM D315-16-60-R08	315.00	327.5	16	5.50	80.00	60.00	C	18.80

Wiper inserts are used on face mill cutters, providing improved surface finish, thus eliminating the use of other finishing cutters