

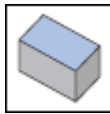

**S845 E45SX-16** : HELIDO 45° face mills using inserts with 8 helical right-hand cutting edges, providing a very economical and a very accurate finish. The dovetail inclined pocket provides a very rigid clamping.

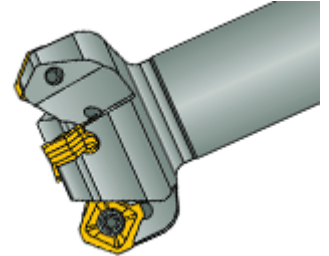
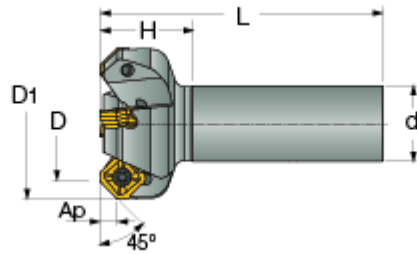

Designation	D	D1	H	L	Z	ap	d	Shank
S845 E45SX D050-04-C32R16	50.00	63.9	40.0	120.00	4	7.15	32.00	C